

BMM Weston

Tunnel Finisher 450 650 1250

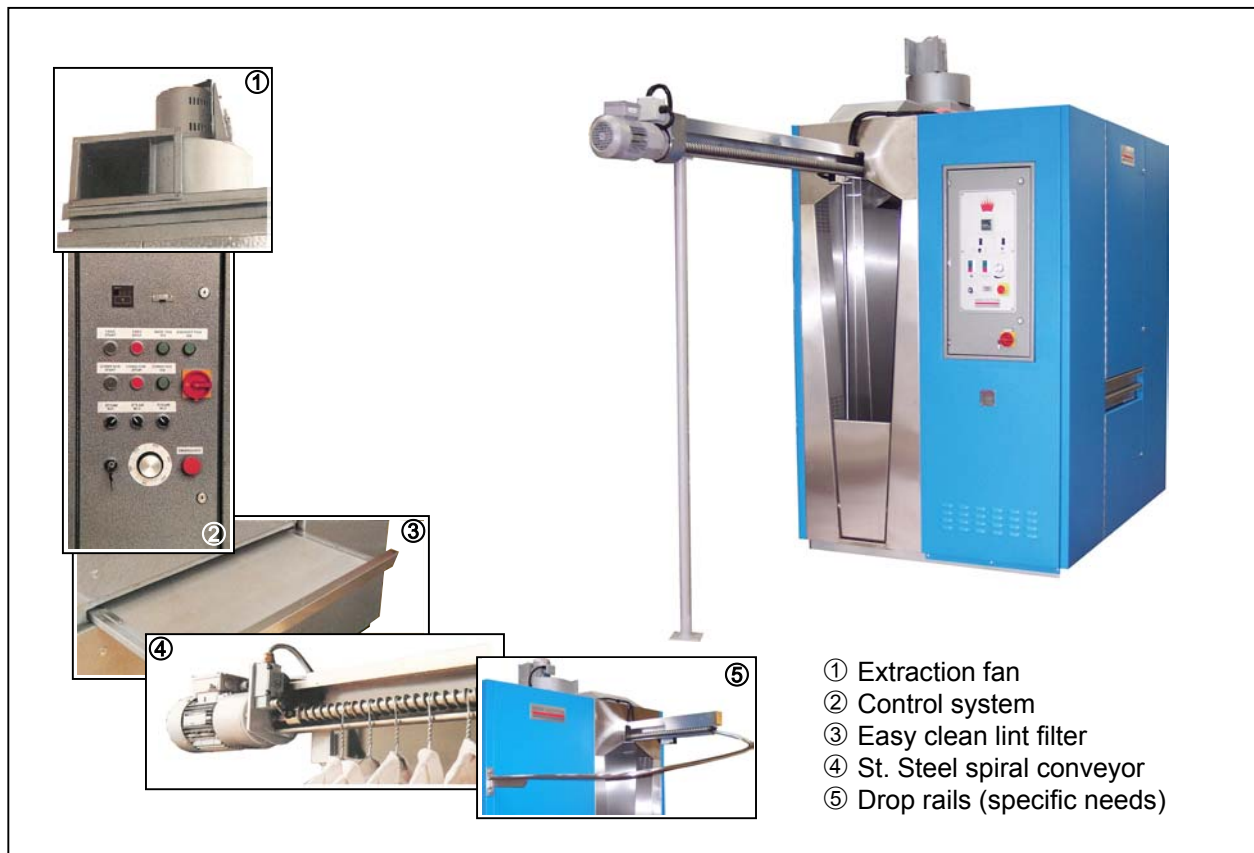

- ① Extraction fan
- ② Control system
- ③ Easy clean lint filter
- ④ St. Steel spiral conveyoyr
- ⑤ Drop rails (specific needs)

BMM Weston Tunnel Finishers are a modular range of ruggedly constructed, simple to operate, compact, hot air / steam finishing tunnels.

They are designed to process all types of polyester/cotton and cotton rich garments for industrial workwear units, the garment industry and hospital laundries, whether washed or dry-cleaned, to high standards at an economic cost.

BMM Weston Tunnel Finishing give:-

- High quality finishing
- High outputs
- Low energy usage
- Flexible, simple operation
- Easy installation
- Simple to service and maintain
- Long commercial life

BMM Weston can provide complete installations to suit specific needs.

Combining an infinitely variable steam spray with sophisticated, controlled conditioned air circulation ensures high quality finishing.

Whether processing cotton rich, or any synthetic / cotton material, the combination of a fine steam spray and very high velocity air flow optimises material movement and stretching to give fast drying and high quality finishing.

Tunnel finisher **450**—up to 200 garments an hour at 30-40% moisture retention.

Tunnel finisher **650**—up to 400 garments an hour at 30-40% moisture retention.

Tunnel finisher **1250**—up to 800 garments an hour at 30-40% moisture retention.

The above figures are intended as a guide only. In addition when processing dry to dry, production rates of up to 350, 550 and 1100 garments respectively, an hour are possible.

Technical Data

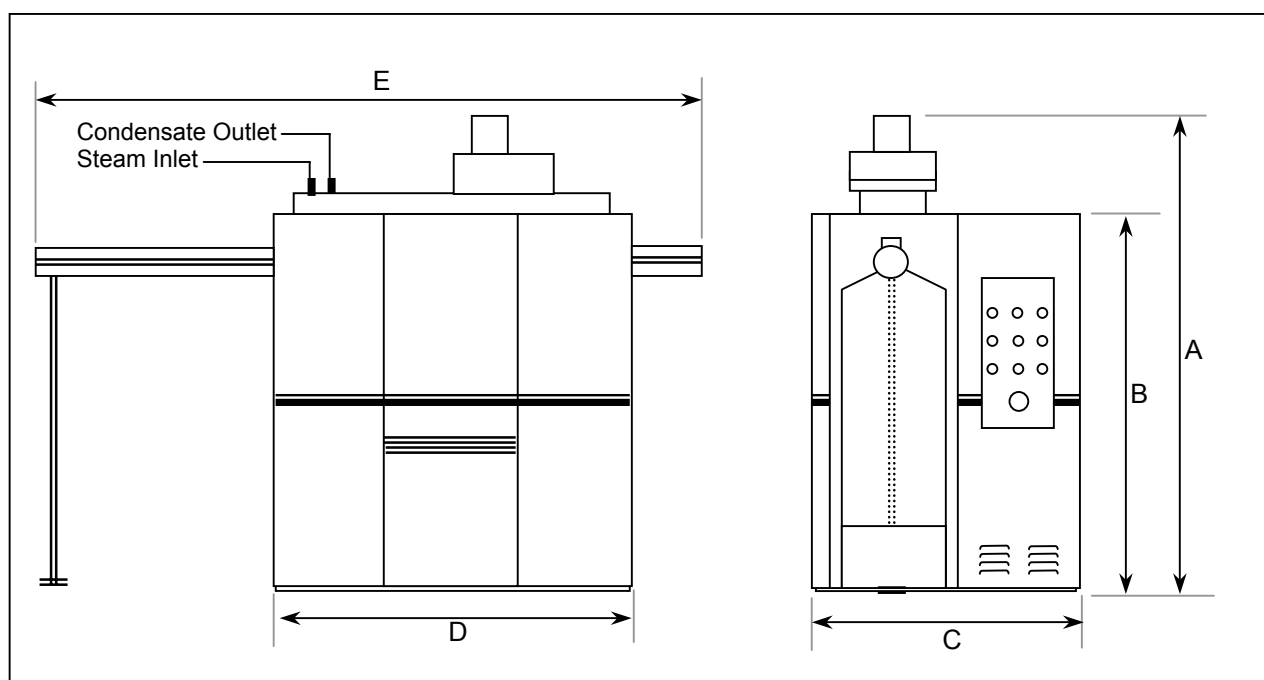

MODEL NO.	450	650	1250
DIMENSIONS			
A	2659 mm 105 in	2659 mm 105 in	2659 mm 105 in
B	2286 mm 90 in	2286 mm 90 in	2286 mm 90 in
C	1465 mm 58 in	1465 mm 58 in	1465 mm 58 in
D	1900 mm 75 in	2250 mm 89 in	3500 mm 138 in
E	4365 mm 172 in	5215 mm 250 in	6430 mm 253 in
TECHNICAL DATA			
Output	200	300 – 400	600 – 800
	Garments per hour at 30 / 40% moisture retention (dependent on steam pressure and garment type).		
Steam Inlet	40 mm (1.5 BSP)	40 mm (1.5 BSP)	40 mm (1.5 BSP)
Steam Supply	10 Bar (150 psi) max	10 Bar (150 psi) max	10 Bar (150 psi) max
Steam Consumption	125 kg/hr (275 lbs/hr)	200 kg/hr (440 lbs/hr)	347 kg/hr (763 lbs/hr)
Condensate outlet	20 mm (3/4 BSP)	20 mm (3/4 BSP)	25 mm (1 BSP)
Electrical Supply	380/440V 3 phase + neutral + earth, 50hz	380/440V 3 phase + neutral + earth, 50hz	380/440V 3 phase + neutral + earth, 50hz
Electrical Loading	415V 3ph – 9 amps	415V 3ph – 17 amps	415V 3ph – 32 amps
Conveyor	Stainless steel screw type. Wire formed. Nominal 50rpm with variable pitch, scroll timed interval between each revolution. Timed interval controlled to vary garment throughput per hour.		
Hangers	Most standard types – heavy gauge 10(swg) recommended for reuse.		